

# Industrial Grade Portable Outlet Boxes & Coverplates



Portable Electrical Outlet Boxes from Leviton are the perfect solution for creating OSHA and NEC Compliant portable power pendants and stringers for temporary power applications.

## Portable Outlet Boxes:

- Available in single-gang and two-gang sizes
- Extremely resistant to heat and harsh chemicals
- Feed-thru and pendant styles available

## Coverplates:

- Available in a variety of styles
- Provide superior impact resistance
- Flip-lid versions are rated NEMA Type 3R

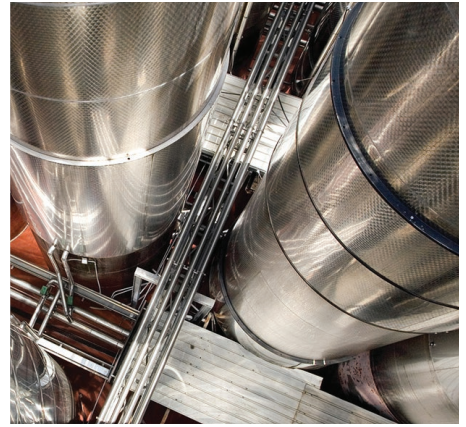

DELIVER THE POWER YOU NEED, WHERE YOU NEED IT



# Features



Non-metallic construction provides protection against electrical shock

Available in pendant and feed-thru styles

Molded TPV housing is extremely durable, even in harsh conditions

Variable adjust strain relief provides superior protection throughout entire range of cable diameters

Available in black or high-visibility yellow

Standard strain relief accepts a wide range of cable diameters

Optional mounting holes provide a more secure fit

Coverplates are extremely durable and impact resistant, providing extended service life

A wide array of cover options is available, including standard coverplates and weather-resistant flip lid versions

## Flexible & Reliable



# Ordering Information

Portable Outlet Boxes and Coverplates, Single-Gang



## SINGLE-GANG OUTLET BOXES

Description	Cable Diameter	Color		Dimensions - see dimensional drawings			Box Volume
		Yellow	Black	Length (A)	Width (B)	Height (C)	
Standard Depth, Pendant Style	0.230" – 0.546"	3059-1Y <sup>2</sup>	3059-1E <sup>2</sup>	3.375"	3.900"	2.500"	16.7 cu in
Standard Depth, Feed-Thru Style	0.230" – 0.546"	3059F-1Y <sup>2</sup>	3059F-1E <sup>2</sup>	3.375"	3.900"	2.500"	16.7 cu in
Extra Deep, Pendant Style	0.230" – 0.546"	3099-1Y	3099-1E	4.375"	3.900"	2.500"	22.3 cu in
Extra Deep, Feed-Thru Style	0.230" – 0.546"	3099F-1Y	3099F-1E	4.375"	3.900"	2.500"	22.3 cu in
Extra Deep, Pendant Style	0.590" – 1.000"	3099-2Y	3099-2E	4.375"	3.900"	2.500"	22.3 cu in
Extra Deep, Feed-Thru Style	0.590" – 1.000"	3099F-2Y	3099F-2E	4.375"	3.900"	2.500"	22.3 cu in

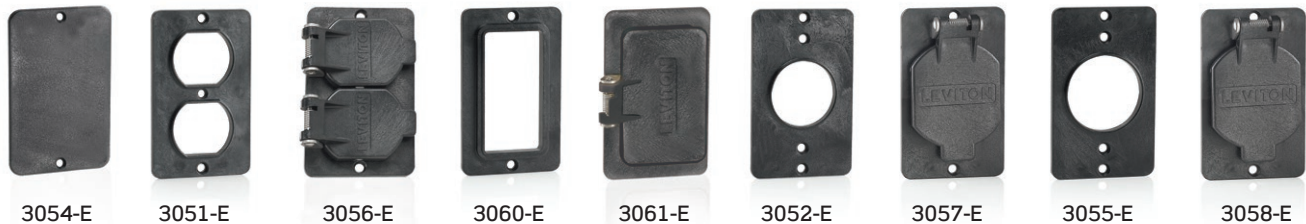

## SINGLE-GANG COVERPLATES - STANDARD & WITH FLIP LIDS

Description	Color	
	Yellow	Black
Blank Coverplate	3054-Y	3054-E
Duplex Receptacle Coverplate	3051-Y	3051-E
Duplex Receptacle Coverplate with Weather-Resistant Flip Lid*	3056-Y	3056-E
GFCI /decora® Receptacle Coverplate	3060-Y	3060-E
GFCI /decora® Receptacle Coverplate with Weather-Resistant Flip Lid* <sup>1</sup>	3061-Y	3061-E
1.39" diameter Single Receptacle Coverplate (15A Straight Blade & Locking/20A Straight Blade Receptacles)	3052-Y	3052-E
1.39" diameter Single Receptacle Coverplate with Weather-Resistant Flip Lid*	3057-Y	3057-E
1.56" diameter Single Receptacle Coverplate (20A & 30A Locking Receptacles)	3055-Y	3055-E
1.56" diameter Single Receptacle Coverplate with Weather-Resistant Flip Lid*	3058-Y	3058-E

\* NEMA Type 3R Rated

<sup>1</sup>Tamper Resistant GFCI devices not compatible <sup>2</sup>GFCI devices not compatible (must use extra deep version)

# Dimensional Drawings

## Portable Outlet Boxes and Coverplates, Single-Gang

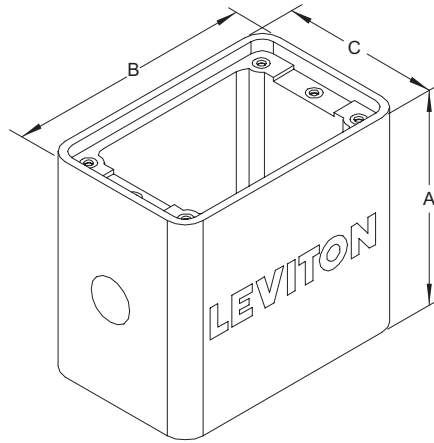

SINGLE-GANG BOX

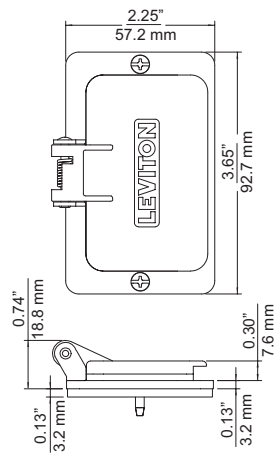

SINGLE-GANG GFCI /DECORA  
COVERPLATE WITH FLIP LID  
TYPICAL

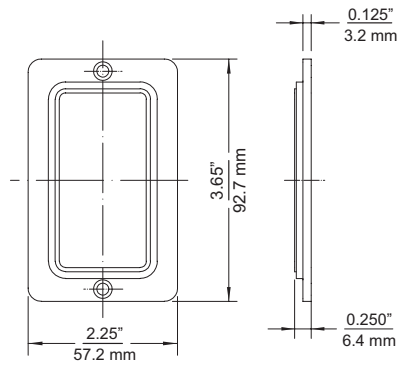

SINGLE-GANG GFCI /DECORA  
COVERPLATE  
TYPICAL

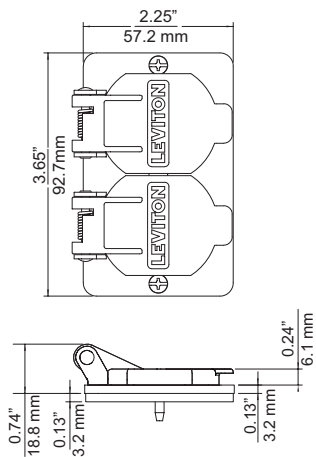

SINGLE-GANG DUPLEX  
COVERPLATE WITH FLIP-LID  
TYPICAL

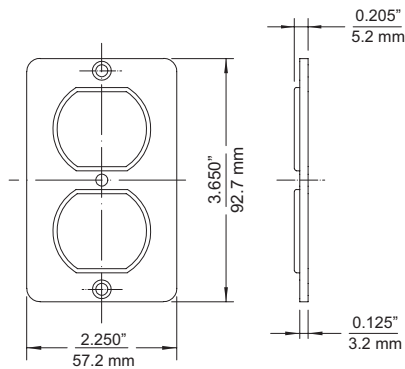

SINGLE-GANG DUPLEX  
COVERPLATE  
TYPICAL

# Ordering Information

## Portable Outlet Boxes and Coverplates, Two-Gang



3200-2Y



3300-2Y



3200F-2Y



TWO-GANG OUTLET BOXES								
Description	Cable Diameter	Color		Dimensions - see dimensional drawings				Box Volume
		Yellow	Black	Length (A)	Width (B)	Depth1 (C)	Depth2 (D)	
Standard Depth, Pendant Style	0.590" – 1.000" <sup>3</sup>	3200-2Y	3200-2E	5.100"	5.655"	4.655"	—	75.7 cu in
Standard Depth, Feed-Thru Style	0.590" – 1.000" <sup>3</sup>	3200F-2Y	3200F-2E	5.100"	5.655"	4.655"	—	75.7 cu in
Angled Depth, Pendant Style	0.590" – 1.000" <sup>3</sup>	3300-2Y	3300-2E	4.300"	5.655"	4.655"	3.200"	53.1 cu in



3265-Y



3260-Y



3260W-Y



3251-Y



3251W-Y



3241-Y



3241W-Y



3262-Y



3262W-Y



3261-Y



3261W-Y



3263-Y



3263W-Y



TWO-GANG COVERPLATES - STANDARD & WITH FLIP LIDS		
Description	Color	
	Yellow	Black
Blank Coverplate	3265-Y	3265-E
2 – Duplex Receptacle Coverplate	3260-Y	3260-E
2 – Duplex Receptacle Coverplate with Weather-Resistant Flip Lid*	3260W-Y	3260W-E
2 – GFCI /decora® Receptacle Coverplate	3251-Y	3251-E
2 – GFCI /decora® Receptacle Coverplate with Weather-Resistant Flip Lid* <sup>1</sup>	3251W-Y	3251W-E
1 – GFCI /decora® Receptacle, 1-Blank Coverplate	3241-Y	3241-E
1 – GFCI /decora® Receptacle with Weather-Resistant Flip Lid, 1 - Blank Coverplate* <sup>1</sup>	3241W-Y	3241W-E
1 – 1.56" dia Single Receptacle, 1 - Duplex Receptacle Coverplate	3262-Y	3262-E
1 – 1.56" dia Single Receptacle with Weather-Resistant Flip Lid, 1 – Duplex Receptacle Coverplate with Weather-Resistant Flip Lid*	3262W-Y	3262W-E
1 – 1.56" dia Single Receptacle, 1 - Blank Coverplate	3261-Y	3261-E
1 – 1.56" dia Single Receptacle with Weather-Resistant Flip Lid, 1 - Blank Coverplate*	3261W-Y	3261W-E
2 – 1.56" dia Single Receptacle Coverplate	3263-Y	3263-E
2 – 1.56" dia Single Receptacle Coverplate with Weather-Resistant Flip Lid*	3263W-Y	3263W-E

\* NEMA Type 3R Rated

<sup>1</sup>Tamper Resistant GFCI devices may not be compatible - consult factory for details. <sup>3</sup>For cable diameters smaller than .590", consult factory for options.

# Dimensional Drawings

Portable Outlet Boxes and Coverplates, Two-Gang

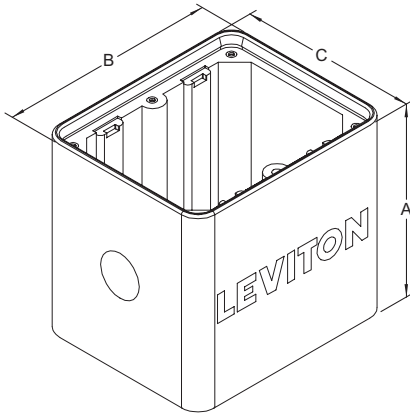

**TWO-GANG BOX**

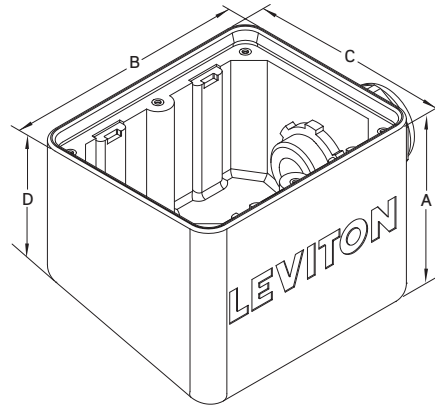

**ANGLE BOX**

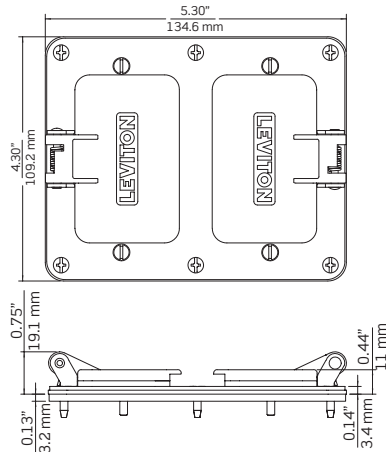

**TWO-GANG DECORA GFCI / DECORA COVERPLATE WITH FLIP-LID**  
TYPICAL

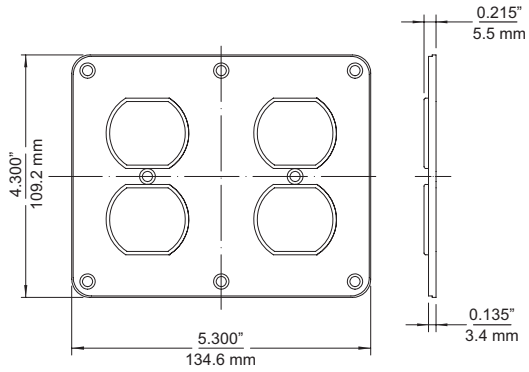

**TWO-GANG DUPLEX COVERPLATE**  
TYPICAL

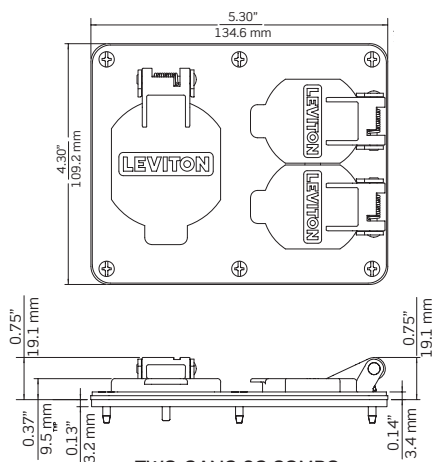

**TWO-GANG 2G COMBO COVERPLATE WITH FLIP-LID**  
TYPICAL

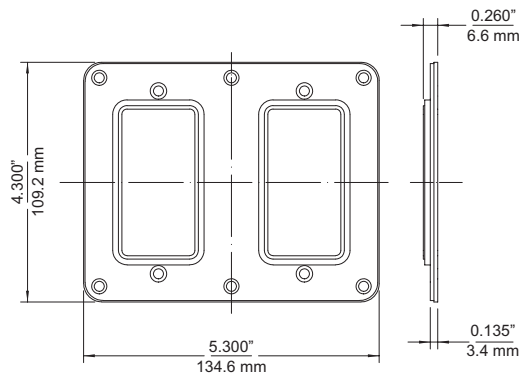

**TWO-GANG / DECORA GFCI COVERPLATE**  
TYPICAL

Perfect for Every Temporary Power Application...



**Leviton Manufacturing Co., Inc.**  
 201 North Service Road, Melville, NY 11747  
 T: 1-800-323-8920 • F: 1-800-832-9538  
 Tech Line (M - F 8am - 10pm, Sat 9am - 7pm,  
 Sun 9am - 5pm / E.S.T.): 1-800-824-3005

**Leviton Manufacturing of Canada, Ltd.**  
 165 Hymus Boulevard, Pointe Claire,  
 Quebec H9R 1E9  
 P: 1-800-469-7890 • F: 1-800-563-1853

**Leviton S. de R.L. de C.V.**  
 Lago Tana 43, Mexico DF, Mexico CP 11290  
 P: (+52) 55-5082-1040 • www.leviton.com.mx

**Leviton Middle East**  
 J/Ali Free Zone, View 19 7th Floor, Office 701  
 PO Box 262742 Dubai, UAE  
 P: +971 4 886 4722 • F: +971 4 886 4723



Visit our website at: [www.leviton.com/industrial](http://www.leviton.com/industrial) email: [industrial@leviton.com](mailto:industrial@leviton.com)