

# Lumina™ RF Wireless Room Control System

Simple energy saving  
wireless retrofits for  
inpatient rooms in  
healthcare facilities

The Lumina™ RF Wireless Room Control System delivers a scalable solution for code-compliant wireless lighting controls for inpatient rooms in healthcare facilities.

Lumina RF Wireless Room Controls deliver wireless control for any on/off, 0-10V and phase cut dimming application. This scalable wireless solution provides the flexibility to easily build a system to meet the unique lighting needs of any space.

Start with a Room Controller for simple switching, dimming and scene control. Then add additional components for multi-location control, occupancy/vacancy sensing, daylight harvesting and more. For additional convenience, the system is configured using the Lumina RF Standalone App—the only setup tool needed.

## CHALLENGE

*Healthcare facility wants to retrofit inpatient rooms lighting with a wireless solution and increase control capabilities.*

- Need for cost-effective LED retrofit with compatible controls
- Spaces require a combination of dimming, scene control, multiple daylighting zones and plug load control
- Must comply with IECC, ASHRAE 90.1 and 2022 Title 24, Part 6 requirements

## SOLUTION

*Lumina RF Room Controls create a simple energy and labor saving lighting retrofit solution.*

- Room Controllers and Load Control Devices add expanded wireless lighting control capabilities
- Lumina RF Standalone App provides easy configuration and commissioning
- Can be used to comply with IECC, ASHRAE 90.1 and 2022 Title 24, Part 6 space/area control, dimming, occupancy/vacancy sensing, automatic shutoff, multi-zone daylight harvesting and receptacle control requirements



**LEVITON®**

## LUMINA RF STANDALONE 0-10V AND PHASE CUT DIMMING AND SCENE CONTROL WITH OPTIONAL OCCUPANCY/VACANCY SENSING, MULTI-ZONE DAYLIGHT HARVESTING AND RECEPTACLE CONTROL

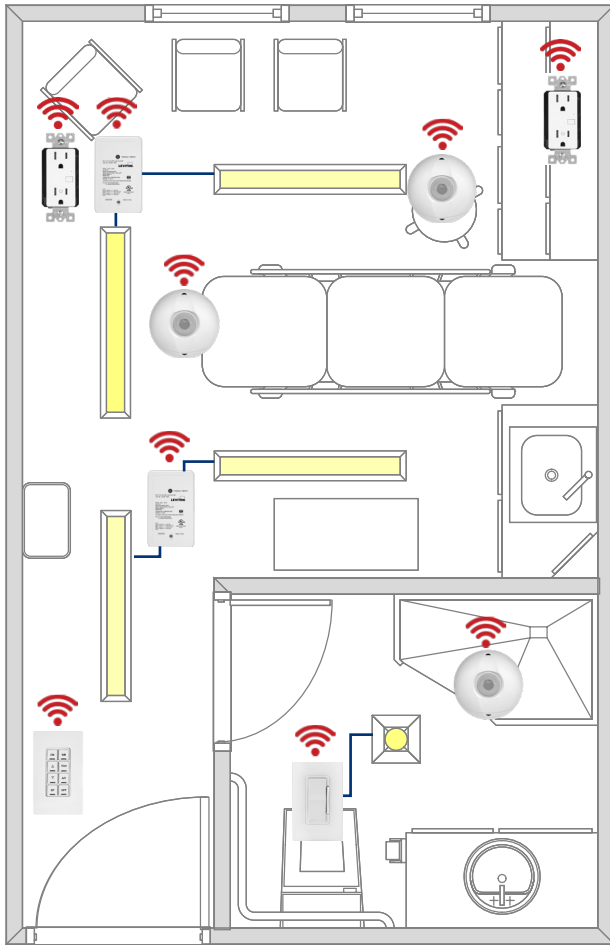

### WHAT YOU WILL NEED

LUMINA RF STANDALONE 0-10V AND PHASE CUT DIMMING AND SCENE CONTROL		QTY
	<b>Lumina RF Keypad Room Controller   DLDNK-08W</b> Coordinates all the energy management functions in a space and provides dimming and scene control	1
	<b>Lumina RF 1000W Dimmer   DL1KD-1BZ</b> Allows for dimming of full phase loads	1
	<b>Wireless, 0-10V Dimming Power Pack   LU107-DNW*</b> Provides wireless control of any 0-10V lamp or fixture	2
	<b>ADD OPTIONAL OCCUPANCY/VACANCY/DAYLIGHT HARVESTING SENSING</b> <b>Wireless PIR Occupancy Sensor &amp; Photocell   ZC015-BIW</b> Provides occupancy/vacancy sensing and light level detection	3
	<b>ADD OPTIONAL RECEPTACLE CONTROL</b> <b>Wireless Controlled Receptacle   ZSTLR-1HW**</b> Install in place of traditional receptacles for plug load control	2

\* Not required if using Intellect-enabled lamps and fixtures. Contact factory for more information.

\*\* LU20S-DNW can be used for an entire 20A receptacle control circuit as an alternative to ZSTLR-1HW at every other receptacle.

## LUMINA RF STANDALONE SWITCHING AND SCENE CONTROL WITH OPTIONAL OCCUPANCY/VACANCY SENSING AND RECEPTACLE CONTROL

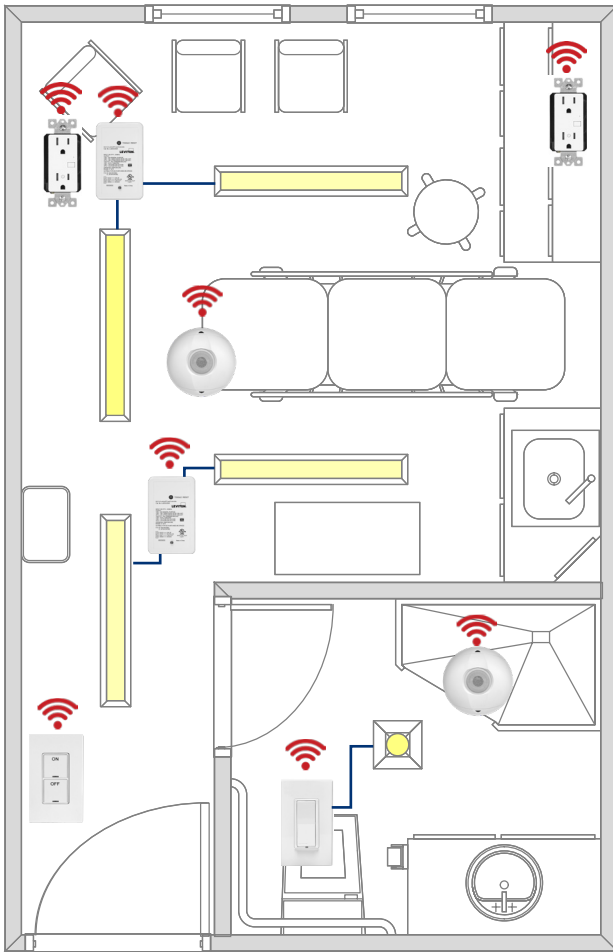

### WHAT YOU WILL NEED

LUMINA RF STANDALONE SWITCHING AND SCENE CONTROL		QTY
	<b>Lumina RF Keypad Room Controller   DLDNK-02W</b> Coordinates all the energy management functions in a space and provides dimming and scene control	1
	<b>Decora Wall Switch Room Controller with 5A Relay   DL05S-D0Z</b> Provides ON/OFF and energy management controls within a space Coordinates all the energy management functions in a space and controls any ON/OFF load	1
	<b>Wireless 20A ON/OFF Switching Power Pack   LU20S-DNW*</b> Provides wireless ON/OFF control for plug and motor loads	2
	<b>ADD OPTIONAL OCCUPANCY/VACANCY SENSING</b> <b>Wireless PIR Occupancy Sensor &amp; Photocell   ZC015-BIW</b> Provides occupancy/vacancy sensing and light level detection	2
	<b>ADD OPTIONAL RECEPTACLE CONTROL</b> <b>Wireless Controlled Receptacle   ZSTLR-1HW**</b> Install in place of traditional receptacles for plug load control	2

\* Not required if using Intellect-enabled lamps and fixtures. Contact factory for more information.

\*\* LU20S-DNW can be used for an entire 20A receptacle control circuit as an alternative to ZSTLR-1HW at every other receptacle.

## LUMINA RF STANDALONE 0-10V AND PHASE CUT DIMMING AND SCENE CONTROL WITH OPTIONAL OCCUPANCY/VACANCY SENSING, MULTI-ZONE DAYLIGHT HARVESTING AND RECEPTACLE CONTROL

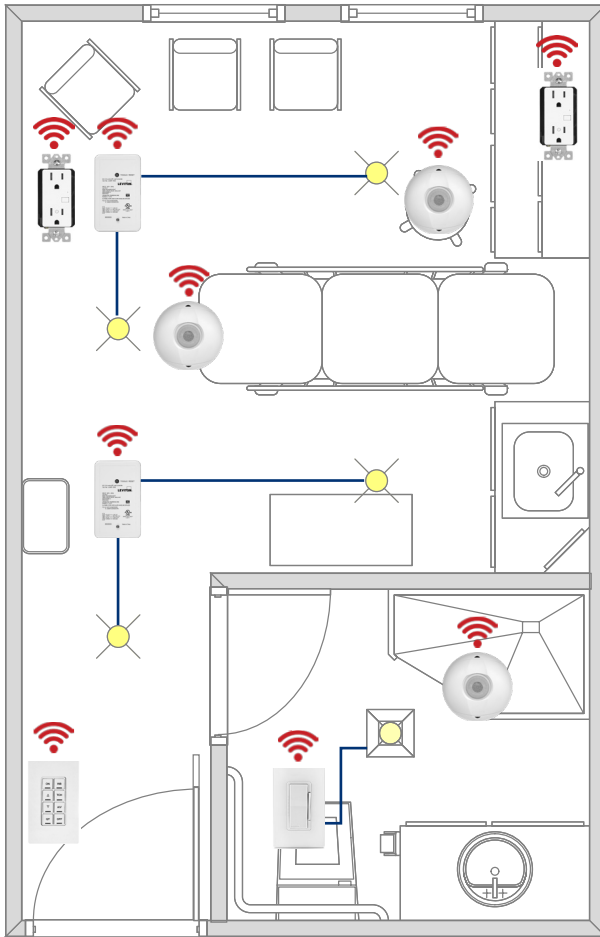

### WHAT YOU WILL NEED

LUMINA RF STANDALONE 0-10V AND PHASE CUT DIMMING AND SCENE CONTROL		QTY
	<b>Lumina RF Keypad Room Controller   DLDNK-08W</b> Coordinates all the energy management functions in a space and provides dimming and scene control	1
	<b>Decora Wireless 0-10V Wall Dimmer   ZS057-D0Z</b> Provides 0-10V dimming control	1
	<b>Wireless Lumina RF 800W Phase Cut Dimming Power Pack   LU04P-1NW*</b> Provides wireless control of any phase cut dimming lamp or fixture	2
	<b>ADD OPTIONAL OCCUPANCY/VACANCY/DAYLIGHT HARVESTING SENSING</b> <b>Wireless PIR Occupancy Sensor &amp; Photocell   ZC015-BIW</b> Provides occupancy/vacancy sensing and light level detection	3
	<b>ADD OPTIONAL RECEPTACLE CONTROL</b> <b>Wireless Controlled Receptacle   ZSTLR-1HW**</b> Install in place of traditional receptacles for plug load control	2

\* Not required if using Intellect-enabled lamps and fixtures. Contact factory for more information.

\*\* LU20S-DNW can be used for an entire 20A receptacle control circuit as an alternative to ZSTLR-1HW at every other receptacle.

#### Leviton Manufacturing Co., Inc. Lighting & Controls

10385 SW Avery Street, Tualatin, OR 97062 tel 503-404-5500 tech line (8:30AM-7:30PM ET Mon-Fri) 800-824-3005

Visit our website at: [www.leviton.com/luminarf](http://www.leviton.com/luminarf)

© 2023 Leviton Manufacturing Co. Inc. All rights reserved. Subject to change without notice.

LES-G-10408B/C23-aa  
REV MAR 2023

