

## Compression F-Connector

### APPLICATION

The Leviton Compression F-Connector is used in video applications such as CATV and satellite. Its radial-compression design provides a more secure termination on Series 6 Quad Shield Cable than the traditional hex-crimp design. For fast installation, terminate using a compression tool that provides a compression stroke of .22" for a finished connector length of 1.06"



### SPECIFICATION

The Compression F-Connector shall be constructed with brass and a tin finish. It shall feature a radial-compression design, providing 360-degree electrical continuity. The connector shall be able to withstand greater than 40 lbs pull force and maintain  $\leq -0.2$  dB up to 1 GHz (typical). The return loss shall be  $\geq -30$  dB up to 1 GHz. The Compression F-Connector shall have RFI shielding of -85 dB (typical).

### FEATURES

- Compatible with compression tool that provides a compression stroke of .22" for a finished connector length of 1.06"

### DESIGN CONSIDERATIONS

- Includes plastic guide pin to determine when cable is properly seated inside the connector
- Comes in packs of 100 pieces

### PHYSICAL SPECIFICATIONS

Dimensions:	See page two
Materials:	Tin-plated brass
Cable Applications:	< 20 lbs max insertion
Cable Interface:	> 40 lbs pull force
Insertion Loss:	$\leq -0.2$ dB up to 1 GHz typical
Return Loss:	$\geq -30$ dB up to 1 GHz typical
RFI Shielding:	-85 dB typical (60% bonded foil) > 70dB to 1GHz
Environmental Range:	-40 °F to 140 °F

### COUNTRY OF ORIGIN

China

### WARRANTY INFORMATION

For a copy of Leviton product warranties, visit [www.leviton.com/warranty](http://www.leviton.com/warranty).

**ELECTRONIC FILES**

For CAD files, typical specs, or technical drawings (.DXF, .DWG), visit [www.leviton.com](http://www.leviton.com).

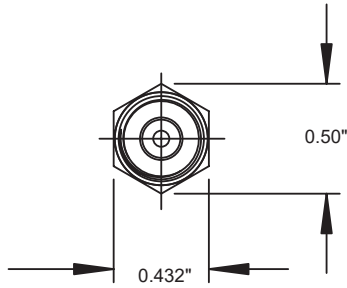

End View

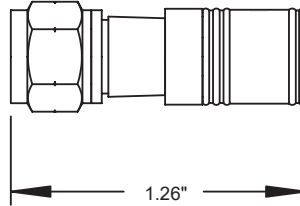

Side View

**40985-CPF**

**PART NUMBERS**

Description	Part No.
Compression F-Connector, 100-pack	40985-CPF

**Leviton Network Solutions**

2222 - 222nd St. SE  
 Bothell, WA 98021-4416

tel 1-800-824-3005  
 tel +1-425-486-2222  
[appeng@leviton.com](mailto:appeng@leviton.com)  
[www.leviton.com](http://www.leviton.com)

**Asia / Pacific**  
 T +1.631.812.6228  
 E [infoasean@leviton.com](mailto:infoasean@leviton.com)

**Europe**  
 T +44.0.1592.772124  
 E [customerserviceeu@leviton.com](mailto:customerserviceeu@leviton.com)

**Canada**  
 T +1.514.954.1840  
 E [pcservice@leviton.com](mailto:pcservice@leviton.com)

**Mexico**  
 T +52.55.5082.1040  
 E [lsmarketing@leviton.com](mailto:lsmarketing@leviton.com)

**Caribbean**  
 T +1.954.593.1896  
 E [infocaribbean@leviton.com](mailto:infocaribbean@leviton.com)

**Middle East & Africa**  
 T +971.4.247.9800  
 E [lmeinfo@leviton.com](mailto:lmeinfo@leviton.com)

**China**  
 T +852.2774.9876  
 E [infochina@leviton.com](mailto:infochina@leviton.com)

**South Korea**  
 T +82.2.3273.9963  
 E [infokorea@leviton.com](mailto:infokorea@leviton.com)

**Colombia**  
 T +57.1.743.6045  
 E [infocolombia@leviton.com](mailto:infocolombia@leviton.com)