

HDF3168 Fiber Distribution Frame

Using Leviton BIM Content in Revit®

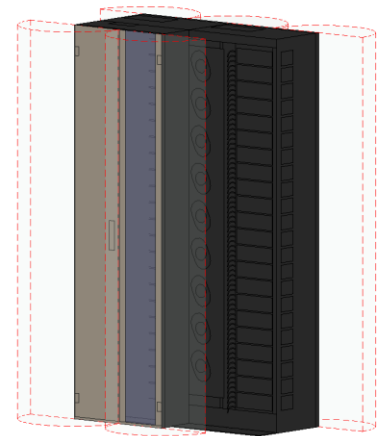

Revit® Family:

Data_Device-Network-Leviton-HDF3168.rfa

Example Project File:

Schedule - Data_Device-Network-Leviton-HDF3168.rvt

Basic Features:

- The Revit® family includes geometry and metadata that represent **HDF3168 Fiber Distribution Frame**.
- The family includes an origin at a midpoint edge location for easy placement.

Loading the family into a project:

- The Revit® family may be loaded into a **Revit® 2012 or later** project through all traditional methods.

Placement:

In plan view:

- If a floor is present, use **Place on Face**. If floor tiles are modeled, the family should snap to the edge of a tile. If a floor is not visible, use **Place on Work Plane**.
- When placing a family, press **Spacebar to rotate** if necessary and click once to place each instance.

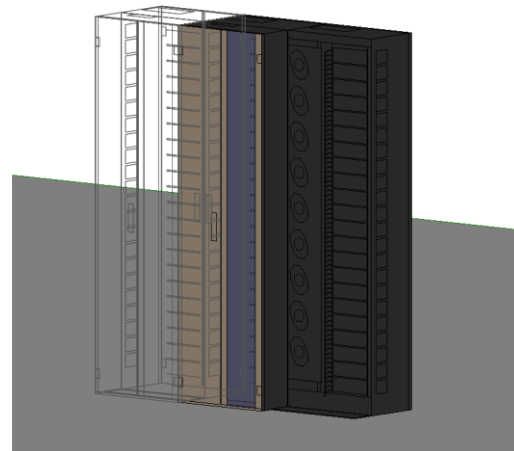

Placing a row of instances in 3D view.

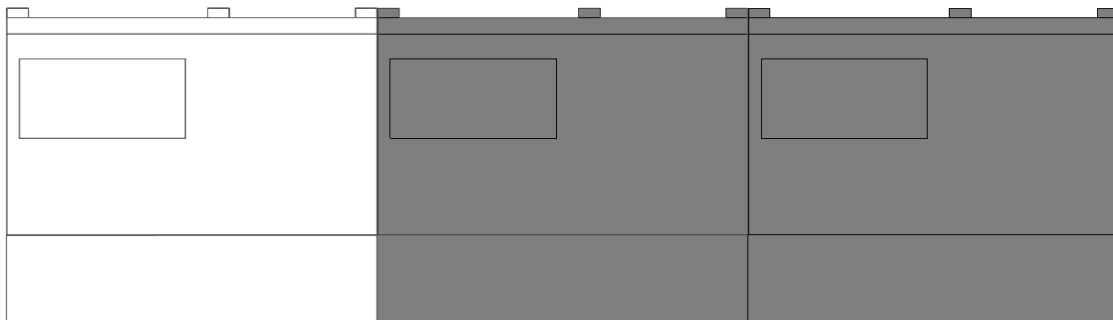

Features and Settings

Instance Properties:

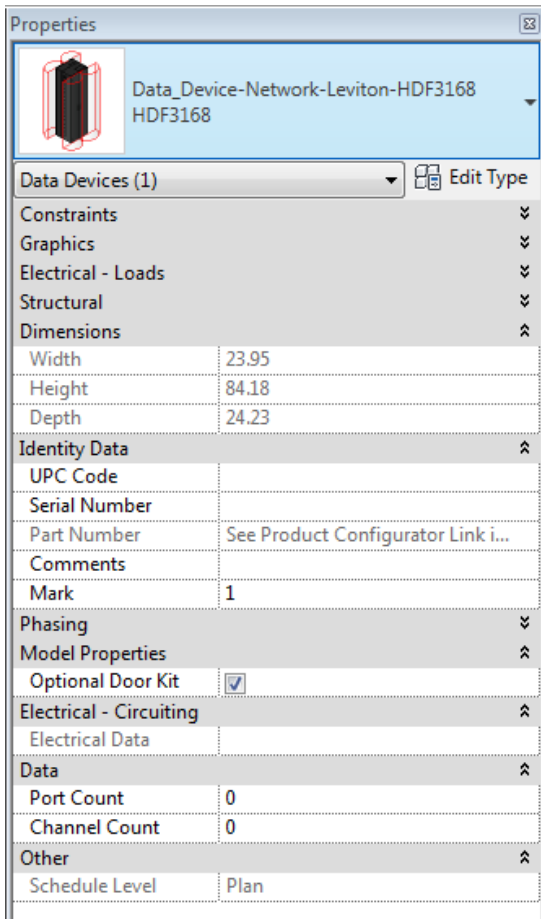

Properties

Data_Device-Network-Leviton-HDF3168
HDF3168

Data Devices (1) Edit Type

Constraints

Graphics

Electrical - Loads

Structural

Dimensions

Width	23.95
Height	84.18
Depth	24.23

Identity Data

UPC Code	
Serial Number	
Part Number	See Product Configurator Link i...
Comments	
Mark	1

Phasing

Model Properties

Optional Door Kit ☒

Electrical - Circuiting

Electrical Data

Data

Port Count	0
Channel Count	0

Other

Schedule Level	Plan
----------------	------

Instance Properties Palette

Dimensions

1. Width
2. Height
3. Depth

Automatically updates based on the **Optional Door Kit (5)** preference.

Identity Data

4. Part Number

See Product Configurator Link in Type Properties.

Model Properties

5. Optional Door Kit

Updates the views (both 2D and 3D) to reflect the optional Door Kit for each instance.

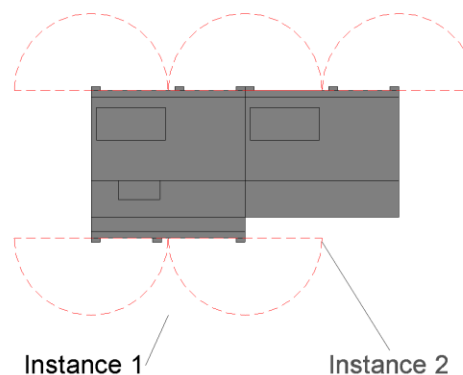

Instance 1 has the Optional Door Kit selected and Instance 2 does not.

Visibility / Graphics:

- Clearance Areas are supplied to assist in planning for adequate door clearance.
- If desired, these may be hidden by unchecking the Clearance Areas checkbox in Visibility / Graphics Overrides.

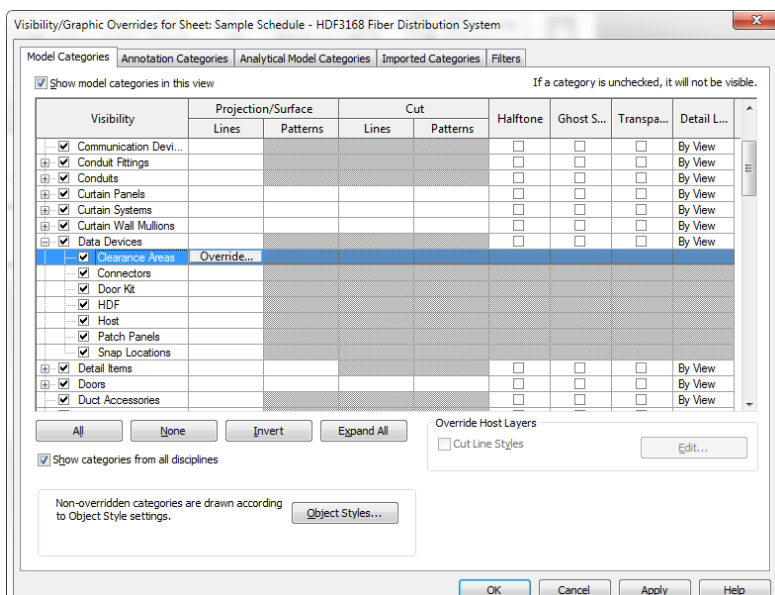

Visibility/Graphic Overrides for Sheet: Sample Schedule - HDF3168 Fiber Distribution System

Model Categories Annotation Categories Analytical Model Categories Imported Categories Filters

☒ show model categories in this view If a category is unchecked, it will not be visible.

Visibility	Projection/Surface		Cut		Haltone	Ghost S...	Transpa...	Detail L...
	Lines	Patterns	Lines	Patterns				
<input checked="" type="checkbox"/> Communication Devi...					<input type="checkbox"/>	<input type="checkbox"/>	<input type="checkbox"/>	By View
<input checked="" type="checkbox"/> Conduit Fittings					<input type="checkbox"/>	<input type="checkbox"/>	<input type="checkbox"/>	By View
<input checked="" type="checkbox"/> Conduits					<input type="checkbox"/>	<input type="checkbox"/>	<input type="checkbox"/>	By View
<input checked="" type="checkbox"/> Curtain Panels					<input type="checkbox"/>	<input type="checkbox"/>	<input type="checkbox"/>	By View
<input checked="" type="checkbox"/> Curtain Systems					<input type="checkbox"/>	<input type="checkbox"/>	<input type="checkbox"/>	By View
<input checked="" type="checkbox"/> Curtain Wall Mullions					<input type="checkbox"/>	<input type="checkbox"/>	<input type="checkbox"/>	By View
<input checked="" type="checkbox"/> Data Devices					<input type="checkbox"/>	<input type="checkbox"/>	<input type="checkbox"/>	By View
<input checked="" type="checkbox"/> Clearance Areas	Override...							
<input checked="" type="checkbox"/> Connectors								
<input checked="" type="checkbox"/> Door Kit								
<input checked="" type="checkbox"/> HDF								
<input checked="" type="checkbox"/> Host								
<input checked="" type="checkbox"/> Patch Panels								
<input checked="" type="checkbox"/> Snap Locations								
<input checked="" type="checkbox"/> Detail Items					<input type="checkbox"/>	<input type="checkbox"/>	<input type="checkbox"/>	By View
<input checked="" type="checkbox"/> Doors					<input type="checkbox"/>	<input type="checkbox"/>	<input type="checkbox"/>	By View
<input checked="" type="checkbox"/> Duct Accessories					<input type="checkbox"/>	<input type="checkbox"/>	<input type="checkbox"/>	By View

All None Invert Expand All

☒ Show categories from all disciplines

Non-overridden categories are drawn according to Object Style settings. Object Styles...

Override Host Layers

☐ Cut Line Styles Edit...

OK Cancel Apply Help